

Biomedical

-30°C Chest Freezer

138 | 221 | 425 L



MDF-237-PE

Power to counteract frequent door openings Biomedical Chest Freezers offer outstanding reliability and performance, as required in a wide variety of storage- and research applications.

Precise & Uniform Storage

Precise and uniform storage temperatures regardless of ambient conditions through microprocessor temperature control.

Stable Temperature Control

Manual defrost provides stable temperature control and does not exhibit transient temperature.

Ease of Use & Intelligent Security

A comprehensive visual and audible alarm system with remote alarm contacts ensures users are aware of any abnormalities and can take appropriate actions.



Outstanding reliability and performance

The outstanding reliability and performance provided are ideal in a wide variety of storage and research applications.



Effective storage

In the medical field they provide effective storage of life-saving blood supplies and vaccines, as well as samples for diagnosis.



Valuable Sample Storage

An ideal storage solution with door lock (key included) for valuable samples.

Biomedical -30°C Chest Freezer



MDF-437-PE

Easy to read digital display

Temperature readings are displayed and controlled in the range of -20oC to -30oC.

Direct Cooling System

The Biomedical -30oC Chest Freezers feature a direct cooling system for uniform temperature control. Manual defrost ensures a stable environment with no large temperature peaks.

Visual LED Alarm Alerts

Audible and flashing LED visual alarms alert users to the unlikely event of either a high or low temperature condition to protect stored products.

Microprocessor Control

Managed and monitored by an integrated microprocessor controller with a comprehensive alarm system and diagnostic functions.

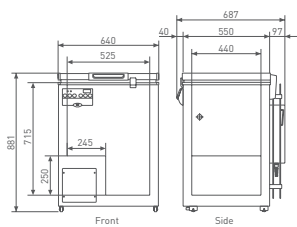

MDF-137-PE

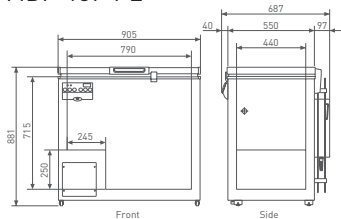

MDF-237-PE

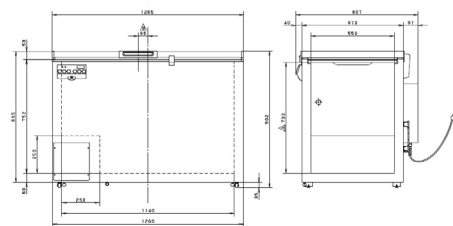

MDF-437-PE

Model Number		MDF-137-PE	MDF-237-PE	MDF-437-PE
Dimensions				
External Dimensions (W x D x H) ¹⁾	mm	640 x 687 x 881	905 x 687 x 881	1265 x 807 x 902
Internal Dimensions (W x D x H)	mm	525 x 440 x 715	790 x 440 x 715	1140 x 550 x 733
Volume	litres	138	221	425
Capacity	2" boxes	51	111	201
Net weight (approx)	kg	52	60	81
Performance				
Cooling performance ²⁾	°C	-30		
Temperature setting range	°C	-18 ~ -35		
Temperature control range ²⁾	°C	-20 ~ -30		
Control				
Controller		Microprocessor		
Display		LED		
Temperature sensor		Thermistor		
Refrigeration				
Cooling method		Direct		
Compressor	W	150	200	250
Refrigerant		HFC		
Insulation material		PUF		
Insulation thickness	mm	55	55	60
Construction				
Exterior Material		Painted Steel		
Interior Material		Coloured aluminium		
Outer lid	qty	1		
Outer lid lock		Y		
Containers / baskets	qty	2	3	4
Max. load per container / basket	kg	10		
Max. load - total	kg	50	80	110
Access port	qty	2		
- position		Right / bottom left		
- diameter	Ø mm	17		
Casters	qty	4 (2 levelling feet)		
Alarms (R = Remote Alarm, V = Visual Alarm, B = Buzzer Alarm)				
Power Failure		V-B-R		
High Temperature		V-B-R		
Low Temperature		V-B-R		
Electrical and Noise Level				
Power Supply	V	230V 50Hz single phase		
Noise Level ³⁾	dB [A]	35	41	42
Options				
Storage systems		MDF-13B2-PW, set of two baskets MDF-13B3-PW, set of three baskets	MDF-43B2-PW, set of two baskets MDF-43B3-PW, set of three baskets	
Temperature recorders				set of three baskets
- Circular type		MTR-G85C-PE		
- Chart paper		RP-G85-PW		
- Ink pen		PG-R-PW		
- Recorder housing		MDF-S740-PW		
- Continuous strip type		MTR-4015LH-PE		
- Chart paper		RP-40-PW		
- Recorder housing		MDF-S3040-PW		

Appearance and specifications are subject to change without notice.

1) Exterior dimensions of main cabinet only, excluding handle and other external projections - See dimensions drawings on website for full details

2) Air temperature measured at freezer centre, ambient temperature +35°C, no load

3) Nominal value - Background noise 20dB

